

TABLE CHAIRS



# OPERATIONS & MAINTENANCE GUIDE \_

BY TABLEPLACECHAIRS \_

## C O N T E N T S

WOOD FURNITURE	03
METAL FURNITURE	03
MARBLE	04
GLASS	04
FABRIC	05
LEATHER	05
FOLDING /STACKING FURNITURE	06
EXTERNAL FURNITURE	06
MILLBOARD FURNITURE	07
PERIODIC MAINTENANCE OF FURNITURE	07
GET IN TOUCH	08

# How to maintain your furniture



## WOOD FURNITURE

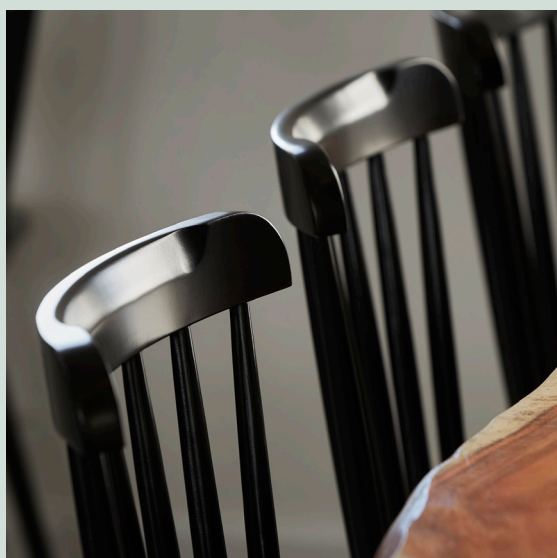

Our polished or laminated surfaces do not require spray cleaners or wax polishes and should be cleaned using a damp cloth and buffed with a dry duster. If proprietary cleaners are used, it is at your risk as they are likely to damage the surfaces over a period of time, breaking down the lacquer resulting in a “sticky feel”.

Polished tabletop surfaces are heat resistant, but must be protected from direct heat using a mat. If you require surfaces to resist higher temperatures, then we advise the use of compact laminates. Avoid dragging objects on the surfaces as this will result in scratching.

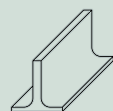

## METAL FURNITURE

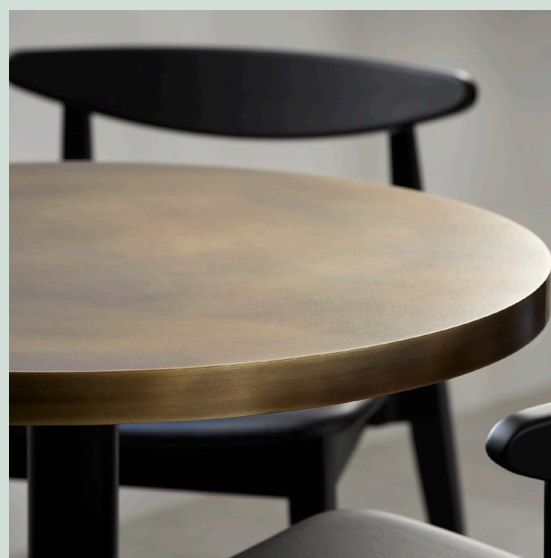

Use warm soapy water as required to clean all surfaces, drying off with a clean cloth. If proprietary cleaners are used, it is at your risk as they can damage the surfaces over a period of time.



# How to maintain your furniture



## MARBLE FURNITURE



Marble is a natural product and therefore porous. Spillages will stain, so we recommend regularly cleaning using a damp cloth and buffing with a dry duster.

If proprietary cleaners are used, it is at your risk as they can damage the surface over a period of time. Use warm soapy water as required to clean all surfaces, drying off with a clean cloth.

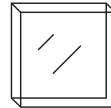

## GLASS FURNITURE



Use warm soapy water as required to clean all surfaces, drying off with a clean cloth. If proprietary cleaners are used, it is at your risk as they can damage the surfaces over a period of time.

Glass is sensitive and fragile. Do not place anything on the glass that has rough or sharp surfaces. We supply tempered glass, which is reinforced, but care must still be taken to avoid accidental breakages.

# How to maintain your furniture



## FABRIC

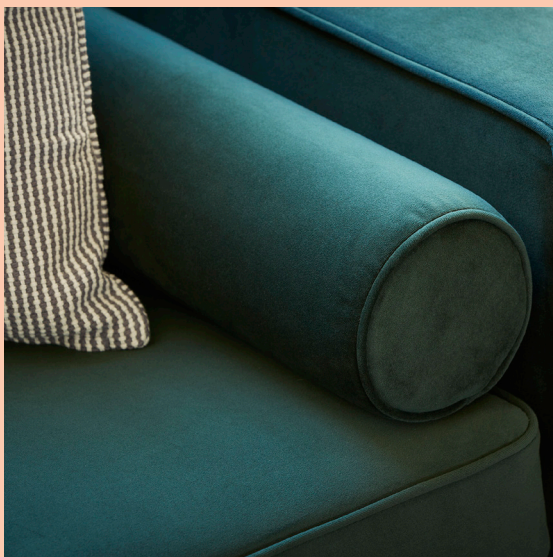

Upholstery covers normally respond to a damp cloth, provided stains are quickly treated. Not all contract fabrics are Scotchgarded, but can be for an additional charge.

Dependent on the construction of a fabric, different cleaning methods will apply, so always refer to the fabric manufacturers' instructions for specific information. If proprietary cleaners are used, then it is at your risk as they can damage the cloth over a period of time.



## LEATHER

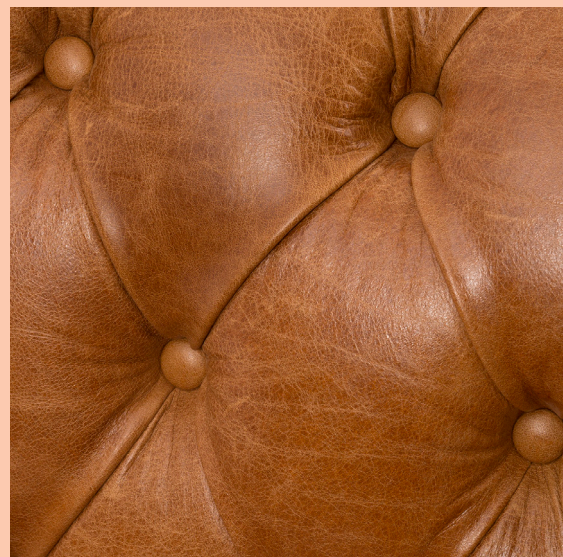

Leather should be treated the same as fabric, but Table Place Chairs\_ can recommend suitable cleaning kits.

Vinyl should be treated the same as fabric, but always refer to the vinyl manufacturers' instructions for specific information. If proprietary cleaners are used, then it is at your risk as they can damage the cloth over a period of time.

# How to maintain your furniture



## STACKING/ FOLDING FURNITURE



When chairs/tables are designed to stack or fold for easy storage, please check for safety restrictions and always use a trolley for moving – never drag them.



## EXTERNAL FURNITURE



External furniture should be regularly maintained according to the manufacturers' recommendations but will weather over time.

Use warm soapy water as required to clean all surfaces, drying off with a clean cloth. If proprietary cleaners are used, then it is at your own risk as they can damage the furniture over a period of time.

Cushions are not waterproof and must be brought indoors.



# How to maintain your furniture



MILLBOARD  
FURNITURE

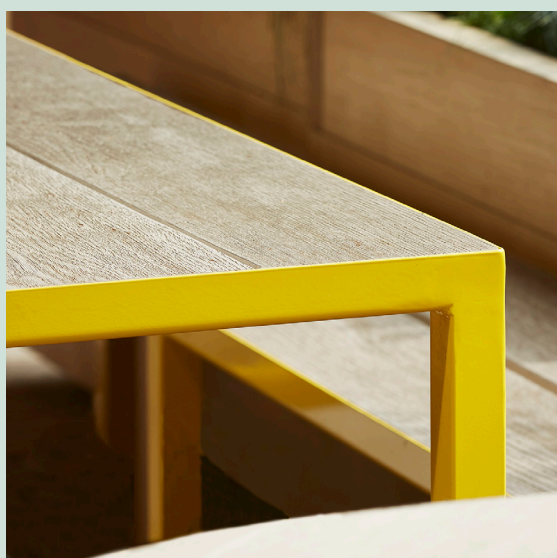

Use warm soapy water as required to clean all surfaces and brush off with a brush before rinsing off. There is no need to use any kind of solvent, chemicals, abrasive cleaners, wax, oil, or any other household cleaners on Millboard tables.

Various floor glides can be fitted to chairs and adjustable ones to tables. However, these cannot be guaranteed over a period of time due to friction and need regular checking. On uneven floors, we recommend StableTable. Please call our Sales Office for further information.



PERIODIC  
MAINTENANCE  
OF FURNITURE



We recommend periodic checking of your furniture for any loose bolts, screws, or fixings. We further recommend that external furniture is protected from extreme weather conditions, particularly during the winter months.

No responsibility will be accepted by Table Place Chairs\_ relating to breakages or damage caused by non-observance of the above points.



T: +44(0)330 1222 117 / E: [info@tableplacechairs.com](mailto:info@tableplacechairs.com) / [@tableplacechairs](https://www.instagram.com/tableplacechairs)

**TABLEPLACECHAIRS.COM**